

Table with 5 columns: ID, DESCRIPTION, TRAVERSE WAY ELEVATION, TRAVERSE WAY ELEVATION + (FAR) PART 77 CLEARANCE REQUIREMENTS, EXISTING PENETRATION, DISPOSITION. Rows T9 to T13.

Table with 5 columns: ID, DESCRIPTION, TRAVERSE WAY ELEVATION, TRAVERSE WAY ELEVATION + (FAR) PART 77 CLEARANCE REQUIREMENTS, FUTURE PENETRATION, DISPOSITION. Rows T10 to T14.

Table with 5 columns: ID, DESCRIPTION, TRAVERSE WAY ELEVATION, TRAVERSE WAY ELEVATION + (FAR) PART 77 CLEARANCE REQUIREMENTS, EXISTING PENETRATION, FUTURE PENETRATION, DISPOSITION. Rows T6 to T24.

Table with 5 columns: ID, DESCRIPTION, TRAVERSE WAY ELEVATION, TRAVERSE WAY ELEVATION + (FAR) PART 77 CLEARANCE REQUIREMENTS, EXISTING PENETRATION, DISPOSITION. Rows T15 to T20.

Table with 5 columns: ID, DESCRIPTION, TRAVERSE WAY ELEVATION, TRAVERSE WAY ELEVATION + (FAR) PART 77 CLEARANCE REQUIREMENTS, FUTURE PENETRATION, DISPOSITION. Rows T16 to T21.

Table with 5 columns: ID, DESCRIPTION, TRAVERSE WAY ELEVATION, TRAVERSE WAY ELEVATION + (FAR) PART 77 CLEARANCE REQUIREMENTS, EXISTING PENETRATION, FUTURE PENETRATION, DISPOSITION. Rows T1 to T5.

NOTE: T1 & T5 FALL OUTSIDE OF APPROACH SURFACE AFTER RUNWAY IS EXTENDED.

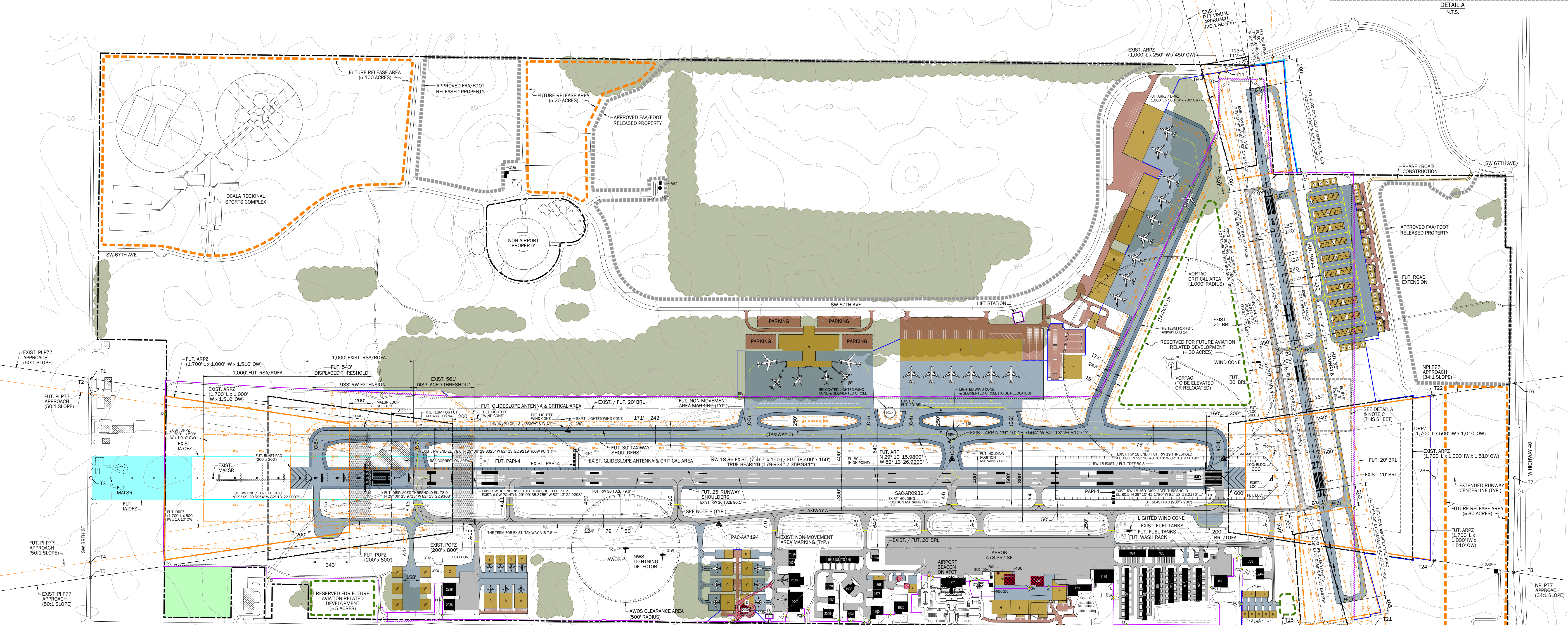
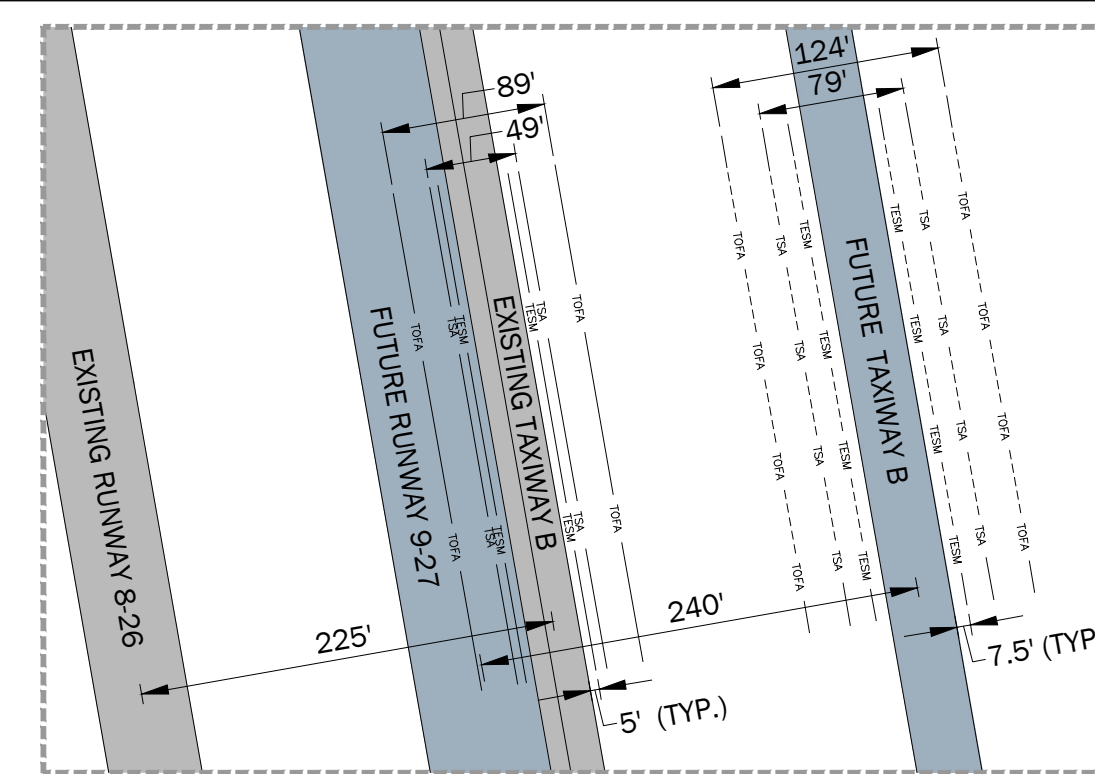

Table with 2 columns: DESIGNER/TECHNICIAN/APN and CHECKED BY/PROJECT NUMBER. Values include APN, RWO, and 23-017.

- GENERAL NOTES: 1. THE (NAVD83) VERTICAL CONTROL DATUM WAS USED FOR ALL ELEVATIONS. 2. THE (NAD83) COORDINATE SYSTEM WAS USED FOR ALL LATITUDE AND LONGITUDE COORDINATES. 3. ALL ELEVATIONS SHOWN ARE ABOVE MEAN SEA LEVEL (AMSL) UNLESS OTHERWISE NOTED. 4. THE BUILDING RESTRICTION LINE (BRL) HAS BEEN ESTABLISHED TO REMAIN BEYOND AND CLEAR OF ALL RUNWAY PROTECTION ZONES (RPZs), OBSTACLE FREE ZONES (OFZs), OBJECT FREE AREAS (OFAs), SAFETY AREAS, NAVIAD CRITICAL AREAS AND ATCT CLEAR LINE OF SIGHT (LOS). 5. EXISTING FENCE HEIGHT IS APPROXIMATELY 6' TALL. IT IS RECOMMENDED THAT FUTURE FENCING IS 7' TALL WITH 1" OF 3 STRAND BARB WIRE PER AC 150/5500-136, SECTION 6.8.2.1. PLAN REFERENCED NOTES: A. THE BUILDING RESTRICTION LINE (BRL) HAS BEEN ESTABLISHED TO REMAIN BEYOND AND CLEAR OF ALL RUNWAY PROTECTION ZONES (RPZs), OBSTACLE FREE ZONES (OFZs), OBJECT FREE AREAS (OFAs), SAFETY AREAS, NAVIAD CRITICAL AREAS AND ATCT CLEAR LINE OF SIGHT (LOS). B. RUNWAY / HOLDING POSITION MARKING SEPARATION DISTANCES ARE AS FOLLOWS: EXISTING 16-36 / FUTURE 1-19 = 250' EXISTING 9-26 = 125' FUTURE 9-27 = 200' C. ONLY A SAMPLE OF TAXIWAY EDGE SAFETY MARGIN (TESM) LINEWORK HAS BEEN SHOWN FOR EXISTING AND FUTURE TAXIWAY B. (SEE DETAIL A THIS SHEET) FOR THE PURPOSE OF CLARITY, THE TESM LINEWORK FOR EXISTING TAXIWAY A AND FUTURE TAXIWAY C HAS NOT BEEN SHOWN. THE TESM FOR TAXIWAY A IS 7.5' FROM EDGE OF PAVEMENT AND THE TESM FOR TAXIWAY C IS 14' FROM EDGE OF PAVEMENT.

Table with 3 columns: ID, DESCRIPTION, GATE TYPE. Rows 1 to 21.

Table with 3 columns: ID, DESCRIPTION, TOP EL. (AMSL). Rows 746 to 3060.

Table with 3 columns: ID, DESCRIPTION, TOP EL. (AMSL). Rows A to Y.

Table with 3 columns: ID, DESCRIPTION, GATE TYPE. Rows 1 to 21.

Table with 3 columns: ID, DESCRIPTION, TOP EL. (AMSL). Rows 746 to 3060.

Table with 3 columns: ID, DESCRIPTION, TOP EL. (AMSL). Rows A to Y.

DRAFT

LEGEND table with columns: DESCRIPTION, EXISTING, FUTURE. Includes entries for AIRPORT PROPERTY LINE, FENCE, AIRPORT BUILDING, OFF-AIRPORT BUILDING, etc.

Table with 4 columns: NO., DESCRIPTION, DATE, BY. Header: REVISIONS.

PROJECT NAME: AIRPORT LAYOUT PLAN PEN & INK UPDATE. DRAWING NAME: AIRPORT LAYOUT PLAN DRAWING. FAIR AP # / STATE GRANT #: PTGA FM450682-1-94-01. DIVISION: PLANNING. DATE: AUGUST 9, 2023. DRAWING NUMBER: 3.